

PARTS LIST						
ITEM	QTY	PART NO.	PART DESCRIPTION	LENGTH	UNIT WT.	NET WT.
1	1	X-SOCX24	24" STANDOFF CROSSOVER WELDMENT	24 in	23.59	23.59
2	2	X-SO12-CLS	V-CLAMP FOR 0.5" HARDWARE	7 9/16 in	3.33	6.66
3	8	G1206	1/2" x 6" HDG HEX BOLT GR5 FULL THREAD	6 in	0.38	3.05
4	8	G12FW	1/2" HDG USS FLATWASHER	3/32 in	0.03	0.27
5	8	G12LW	1/2" HDG LOCKWASHER	1/8 in	0.01	0.11
6	8	G12NUT	1/2" HDG HEAVY 2H HEX NUT	7/8 in	0.07	0.57
TOTAL WT. #						34.26

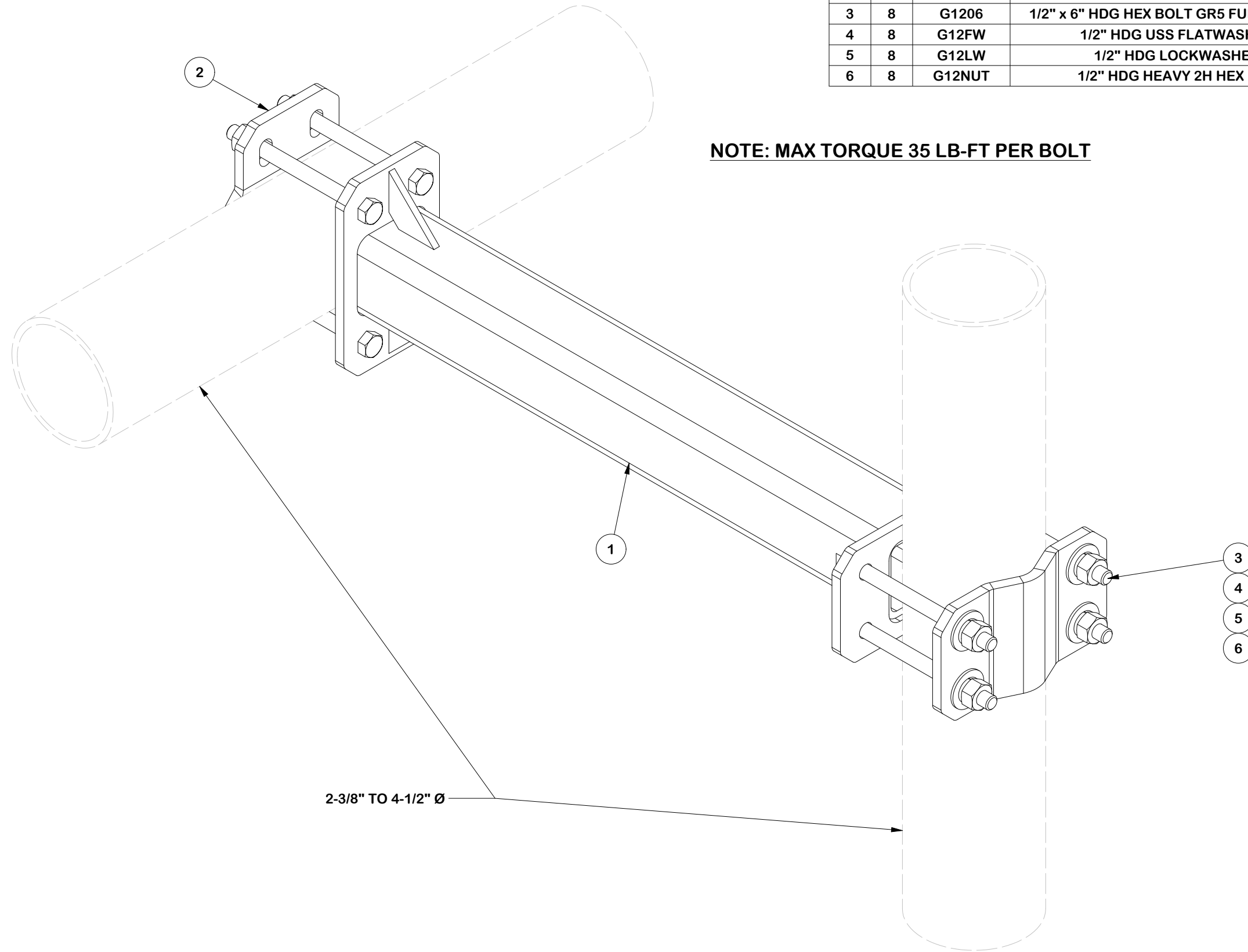

NOTE: MAX TORQUE 35 LB-FT PER BOLT

FINISH:
HOT DIP GALVANIZED.

TOLERANCE NOTES

TOLERANCES ON DIMENSIONS, UNLESS OTHERWISE NOTED ARE:
 SAWED, SHEARED AND GAS CUT EDGES ($\pm 0.030"$)
 DRILLED AND GAS CUT HOLES ($\pm 0.030"$) - NO CONING OF HOLES
 LASER CUT EDGES AND HOLES ($\pm 0.010"$) - NO CONING OF HOLES
 BENDS AND ANGLES ARE $\pm 1/2$ DEGREE
 ALL OTHER MACHINING ($\pm 0.030"$)
 ALL OTHER ASSEMBLY ($\pm 0.060"$)

PROPRIETARY NOTE:
 THE DATA AND TECHNIQUES CONTAINED IN THIS DRAWING ARE PROPRIETARY INFORMATION OF VALMONT INDUSTRIES AND CONSIDERED A TRADE SECRET. ANY USE OR DISCLOSURE WITHOUT THE CONSENT OF VALMONT INDUSTRIES IS STRICTLY PROHIBITED.

DESCRIPTION
24" UNIVERSAL STANDOFF CROSSOVER KIT

SITE PRO 1
 A valmont COMPANY
 Engineering Support Team:
 1-888-753-7446

REV	DESCRIPTION OF REVISIONS	CPD	BY	DATE
A	REVISED X-SOCX24 AND CHANGED TO 1/2" HW	SP1	SDR	8/4/2025
REVISION HISTORY				

CPD NO. SP1	DRAWN BY SDR	2/4/2025	ENG. APPROVAL 9/18/2025
CLASS 87	SUB 02	DRAWING USAGE CUSTOMER	CHECKED BY JET
		9/18/2025	

PART NO. SOCX24-U	1 OF 1 PAGE
DWG. NO. SOCX24-U	